

# GENERAL ARRANGEMENT

## 4,300 TEU CLASS CONTAINER CARRIER

PLAN HISTORY		
DATE	REV. NO.	DESCRIPTION
2008-07-16	001	ORIGINALLY PREPARED FOR S415/16/17/18/19/20.
2009-03-03	002	ISSUED FOR WORKING.

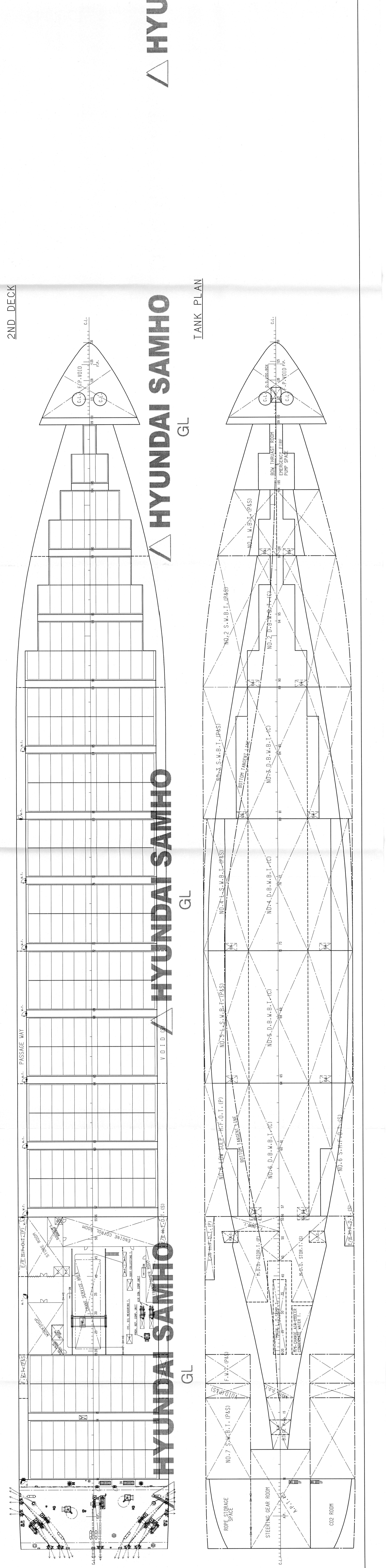
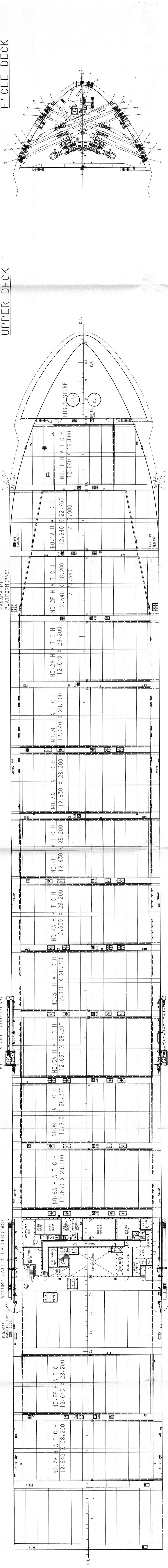
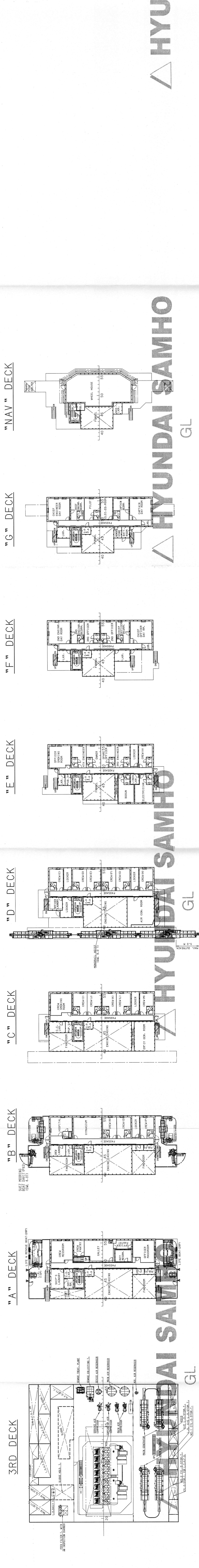
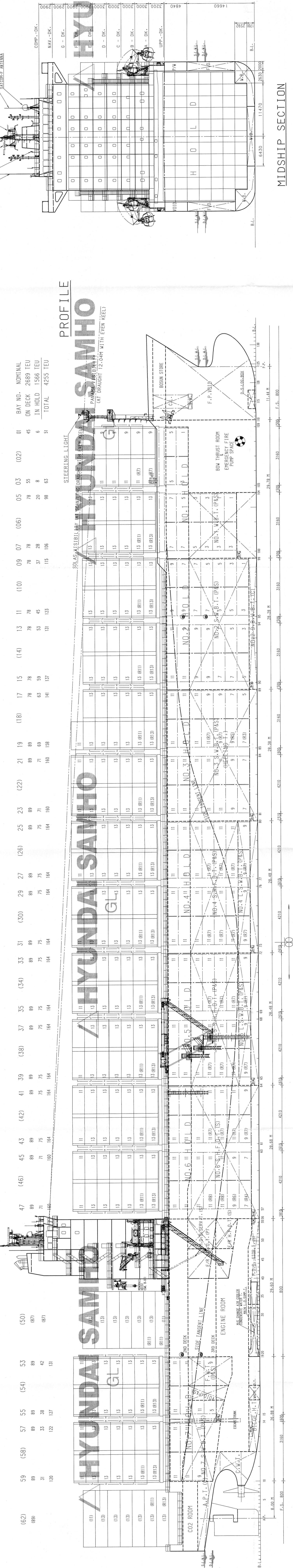

**HYUNDAI SAMHO**  
GL

**HYUNDAI SAMHO**  
GL

**HYUNDAI SAMHO**  
GL

PRINCIPAL PARTICULARS

LENGTH O. A.	282
LENGTH B. P.	248.0
BREADTH MLD.	32.2
DEPTH	19.5
DRAUGHT (DESIGN)	10.8
DRAUGHT (SCANTLING)	12.5

REGISTRATION : LIBERIA  
 CLASS : SOLAS II-2 Reg. 19, HMC, AUT. NAV-0, IM, BWM  
 MAIN ENGINE : Hyundai-Wärtsila RTA82C(S415/16)  
 Nominal rating : 36,100 kW X 102 rpm  
 NO. 1 : 36,100 kW X 102 rpm  
 NO. 2 : 36,100 kW X 102 rpm  
 Nominal rating : 31,640 kW X 102 rpm  
 NO. 1 : 31,640 kW X 102 rpm  
 NO. 2 : 28,476 kW X 98.5 rpm

NO.	NAME	SCALE	DATE	CONSOLIDATED NO.
1	1. H. LEE	1/200	2008-07-16	18-7000-001
2	C. KANE			

HYUNDAI SAMHO HEAVY INDUSTRIES CO., LTD. 2008-07-16

GENERAL ARRANGEMENT